



Manufacturer
 JUNG Hebe- und Transporttechnik GmbH
 Waiblingen, Germany
 Made in Germany

Working Load Limits of eye bolts



Fixed eye bolts
 STANDARD fork clamps are
 outfitted with **FIXED** eye bolts.



Swivel eye bolts
 DELUXE fork clamps are
 outfitted with **SWIVEL** eye bolts.

INSTRUCTION MANUAL

Recommended Use

Safely secure your load to your forklift forks.
 Use only as directed. The manufacturer or supplier is not liable for any damage resulting from improper use. Accidents resulting from improper use are the responsibility of the user. The user must read the operating instructions carefully before use. In particular, attention should be paid to: Working load limits are reduced with angle of use.

Parts Included

Set includes two (2) eye type and two (2) screw type Fork Fangs. Optional accessories: Set of ratchet straps.

Specifications

Bind Capacity per Set: 4400 lbs
 Bind Capacity per individual bracket: 1100 lbs
 ATTENTION: Capacity is reduced with angle of use. See on right .

Operating Temperatures

The equipment is designed for use under normal weather conditions and temperatures between -5 degree and 45 degrees Celsius (23- and 113-degree Fahrenheit).

Safety

- The equipment shall be used and operated only by qualified, trained and skilled operators. No unauthorized person or anyone not familiar with its operation should attempt to use the equipment.
- Inspect the equipment before use. Stop use immediately if the equipment is NOT in good condition.
- For safe working consult and adhere to any applicable safety regulations.
- No person shall work in the close vicinity of the load and no person shall work underneath the load.

Operating Instructions



Eye Type Screw Type

How to use:

1. Adjust the width of the screw type clamps to fit the fork width.
2. Slide screw type clamps to rear area of forks and clamp securely in place by tightening bolts.
3. Grab the load with the forks.
4. Slide Eye Type Clamps onto the front of the forks.
5. Run appropriate sling or chain from rear Screw Type clamps to front Eye Type Clamps overtop of load and secure.

Adjustable width

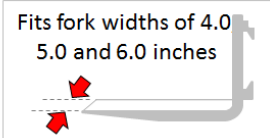

Screw type

The screw type brackets are adjustable in width and height.

The width can be adjusted to two fixed widths to accommodate different size forks.

The height adjusts seamlessly as the compression bolts clamp down and secure the bracket in place (even if the side walls overhand and do not touch the fork).

Adjustable height

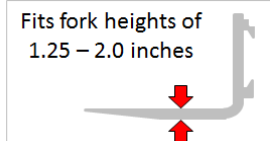
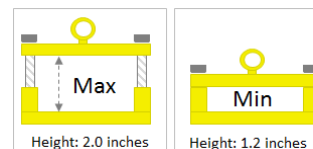

Working Load Limit reduced at angles of use

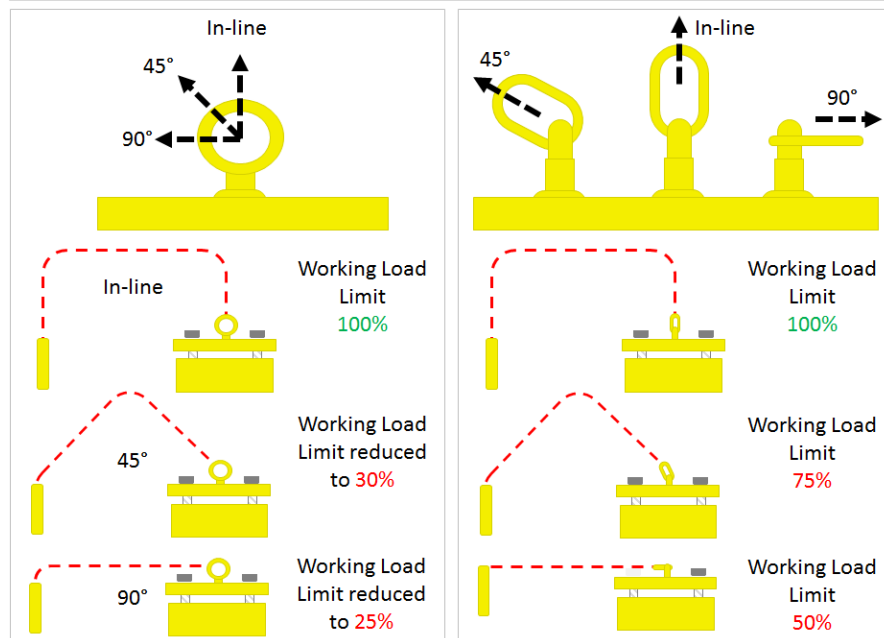

Warnings

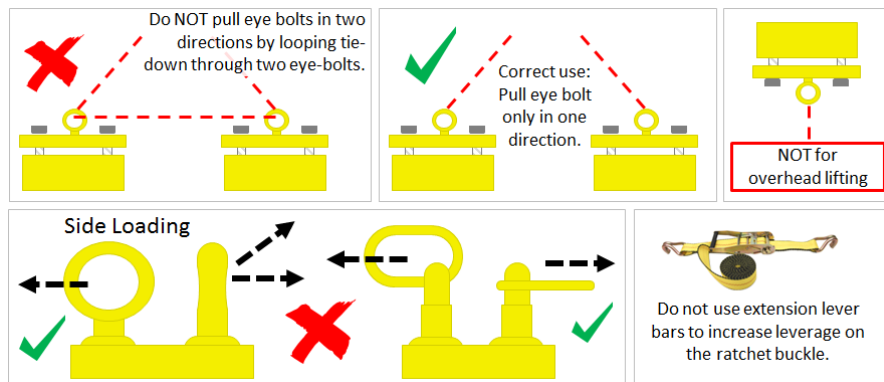

Manufacturer and manufacturer's agent is NOT responsible for ANY loss, liability, injury or damage which results from use of the product, including any and all operation of the product, from misuse and abuse to operation of faulty or defective products to proper use which results in a mistake or accident.